

# Pompes et moteurs à engrenages Bombas de engranajes

Standard

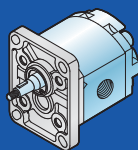

SAE AA

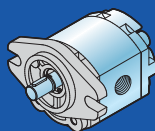

MC 32

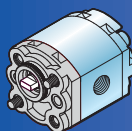

E 32 BX

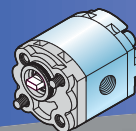

E 32 CX

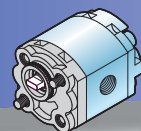

## GRUPE BOMBAS GRUPO 1

Taille nominale Tamaño	Cylindrée Cilindrada	Pression maxi d'utilisation Presión máxima Continuo P1	Pression maxi de pic Presión máxima Pico P3	Vitesse maxi de rotation Velocidad máx.	Débit max. Caudal máx.	Rendement volumétrique min. Rendimiento volumétrico mín. %
	[cm <sup>3</sup> /g] - (cm <sup>3</sup> /rev)	[bar] - (bar)	[bar] - (bar)	[g/min] - (rpm)	[lt/min] - (lit/min)	
1SP_0.9	0.89 (0.05)	240 (3480)	290 (4205)	6000	5.3 (1.40)	92*
1SP_1.2	1.18 (0.07)	240 (3480)	290 (4205)	6000	7.1 (1.88)	
1SP_1.6	1.6 (0.10)	240 (3480)	290 (4205)	6000	9.6 (2.54)	
1SP_2.0	2.0 (0.12)	220 (3190)	270 (3915)	5500	11 (2.91)	95*
1SP_2.5	2.5 (0.15)	220 (3190)	270 (3915)	5000	12.5 (3.30)	
1SP_3.2	3.2 (0.20)	210 (3045)	260 (3770)	4500	14.4 (3.80)	
1SP_3.7	3.7 (0.23)	210 (3045)	260 (3770)	4000	14.8 (3.91)	
1SP_4.2	4.2 (0.26)	190 (2755)	230 (3335)	3500	14.7 (3.88)	
1SP_5.0	5.0 (0.31)	180 (2610)	230 (3335)	3000	15 (3.96)	
1SP_6.3	6.3 (0.38)	170 (2465)	210 (3045)	2700	17 (4.49)	
1SP_7.8	7.76 (0.47)	170 (2465)	210 (3045)	2500	19.4 (5.13)	
1SP_9.8	9.78 (0.60)	150 (2175)	190 (2755)	2000	19.6 (5.18)	

Standard

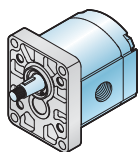

SAE A

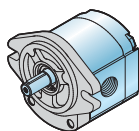

SAE A-OR

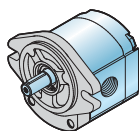

B80 C

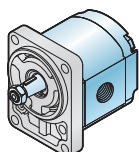

B50 C

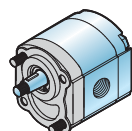

E52 C

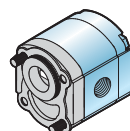

PRKS 400D

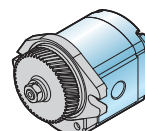

SAE A 14\*

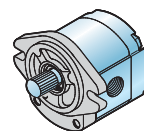

## GRUPE BOMBAS GRUPO 2

Taille nominale Tamaño	Cylindrée Cilindrada	Pression maxi d'utilisation Presión máxima Continuo P1	Pression maxi de pic Presión máxima Pico P3	Vitesse maxi de rotation Velocidad máx.	Débit max. Caudal máx.	Rendement volumétrique min. Rendimiento volumétrico mín. %
	[cm <sup>3</sup> /g] - (cm <sup>3</sup> /rev)	[bar] - (bar)	[bar] - (bar)	[g/min] - (rpm)	[lt/min] - (lit/min)	
2SP_4	4 (0.24)	280 (4060)	320 (4640)	4000	16 (4.23)	95*
2SP_6	6 (0.37)	280 (4060)	320 (4640)	4000	24 (6.34)	
2SP_8	8.5 (0.52)	280 (4060)	320 (4640)	3500	29.7 (7.85)	
2SP_11	11 (0.67)	280 (4060)	320 (4640)	3500	38.5 (10.17)	
2SP_14	14 (0.85)	270 (3915)	290 (4205)	3500	49 (12.95)	
2SP_16	16.5 (1.01)	230 (3335)	250 (3625)	3500	57.7 (15.24)	
2SP_19	19.5 (1.19)	210 (3045)	230 (3335)	3300	64.3 (16.99)	
2SP_22	22.5 (1.37)	190 (2755)	210 (3045)	2800	63 (16.64)	
2SP_26	26 (1.59)	170 (2465)	190 (2755)	2500	65 (17.17)	

Standard

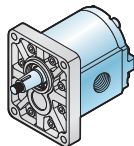

SAE B

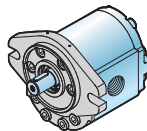

SAE B-OR

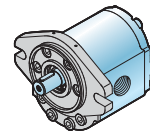

ZFC

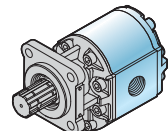

## GRUPE BOMBAS GRUPO 3

Taille nominale Tamaño	Cylindrée Cilindrada	Pression maxi d'utilisation Presión máxima Continuo P1	Pression maxi de pic Presión máxima Pico P3	Vitesse maxi de rotation Velocidad máx.	Débit max. Caudal máx.	Rendement volumétrique min. Rendimiento volumétrico mín. %
	[cm <sup>3</sup> /g] - (cm <sup>3</sup> /rev)	[bar] - (bar)	[bar] - (bar)	[g/min] - (rpm)	[lt/min] - (lit/min)	
3SP_19	19 (1.16)	270 (3915)	320 (4640)	3500	66.5 (17.57)	95*
3SP_22	22.3 (1.36)	260 (3770)	300 (4350)	3500	78 (20.61)	
3SP_29	29.3 (1.79)	240 (3480)	280 (4060)	3300	96.7 (25.55)	
3SP_33	32.9 (2.01)	240 (3480)	280 (4060)	3300	108.6 (28.69)	
3SP_36	36.4 (2.22)	230 (3335)	270 (3915)	3300	120.1 (31.73)	
3SP_44	43.5 (2.65)	200 (2900)	240 (3480)	3000	130.5 (34.48)	
3SP_52	51.7 (3.15)	200 (2900)	240 (3480)	3000	155.1 (40.98)	
3SP_62	61.1 (3.73)	180 (2610)	200 (2900)	2500	152.7 (40.34)	

(valeurs relevées pendant l'essai à 1500 tours/min, avec pression P1 / Valores obtenidos durante la prueba con 1500 rev/min y con presión P1)